

REDUCED TEE 90°

03 Update - 04/2024

TECHNICAL DATA

Article No	001 115 0042 0113
d1 (mm)	110
d2 (mm)	63
L (mm)	327
le1 (mm)	87
le2 (mm)	67
Z (mm)	149
s1 (mm)	6,6
s2 (mm)	3,8
Weight (Kg)	0,975
Box Quantity (pcs)	14
Box Dimension (pcs)	36x60x46,5

INJECTION MOULDED

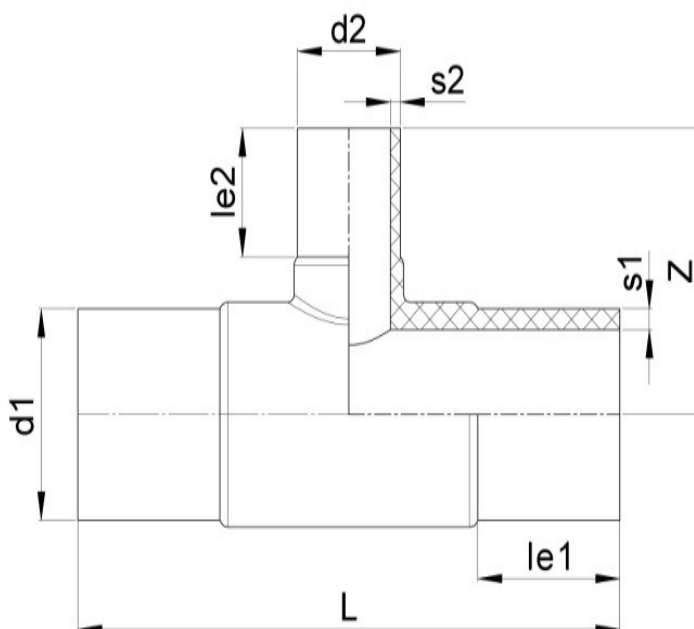

IDENTIFICATION OF PRODUCT

D(mm)	110-63
SDR	17
RAW METARIAL	PE 100
PRESSURE CLASS	10 Bar Water 6 Bar Gas
TRADEMARK	NTG
EXECUTION	Injection Moulded
STANDARD	EN 12201-3 EN 1555-3 AS /NZS 4129

SPECIFICATION

Long Spigot

Tolerance on diameters and thickness according to the standards. The other dimensions are specialized. Tolerance $\pm 5\%$. NTG PLASTIK reserves all the right to change any information without giving prior notice. The production, distribution and utilization of this document without explicit authorization is prohibited.